

## CUSTOMER'S ISSUE

Customer wanted state of the art cleanroom design applying latest techniques but at realistic price.

**Objective:**

- Enhance the cleanroom design transgressing traditional concepts with innovative ideas.

## CPME SOLUTION

**Description of the CPME solution:**

- ✓ Cleanroom Design Enhancements
- ✓ Automation extended to every stage of the process.

### Cleanroom Design Enhancements.



*Introduction of the concept of split package turnkey vendor scopes of supply.*



*Careful consideration of process and space design to minimise costly high classification cleanroom areas.*

*Integration of selected European and Chinese supplied equipment without significant increased cost.*

**Automation extended to every stage of the process.**

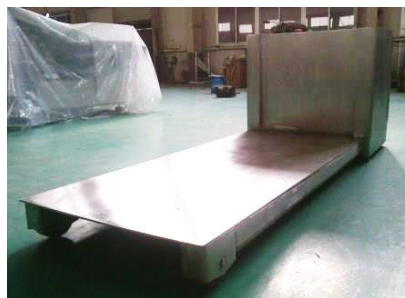
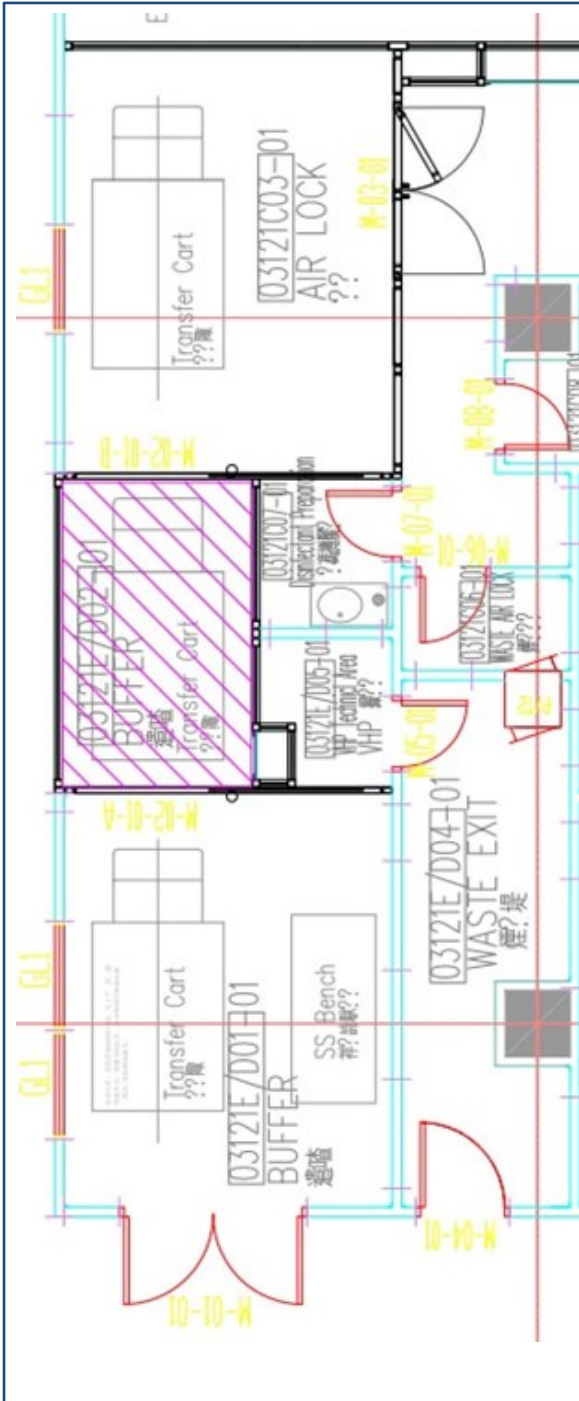

*Three room concept with separate barrier room with no human interface.*

*Use of VHP gassing systems in barrier room.*

*Use of MES for full traceability.*

*Use of fully automated stainless steel remote controlled transfer vehicle.*

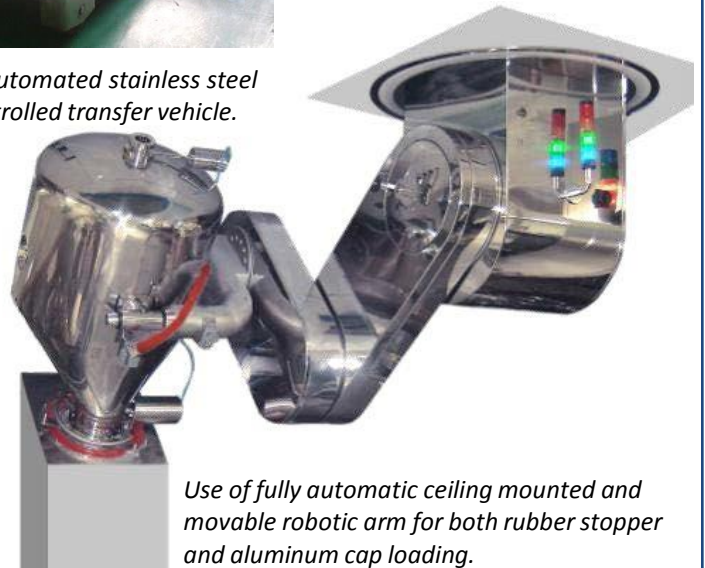

*Use of fully automatic ceiling mounted and movable robotic arm for both rubber stopper and aluminum cap loading.*